

## Installation Instructions

### TouchBoard Mobile Height Adjustable Centre Column TBMS-MOB-HA-CENT

#### **Warning**

Severe personal injury, possible death and property damage can result from improper installation or assembly. Read the following warning carefully before commencing installation:

- This product must only be installed by a qualified audio visual installer or suitably licensed tradesman.
- If you do not understand the instructions or have any concerns or questions, please stop installation immediately and contact TouchBoard or your local supplier.
- Do not continue with installation if hardware is damaged or missing. If hardware is damaged or missing please contact TouchBoard or your local supplier.
- Only use this product for its designed purpose and within stated manufacture specifications.
- The manufacturer disclaims any liability for the modification, improper installation or use of product outside its weight range. The manufacturer will not be liable for any death, injury or damages arising out of the use, or inability to use this product.

Specifications - For TV Panels: 55" – 108"

Max Load: 82kg - Max Shelf Load: 13kg

VESA: 400x400 – 1200x600mm

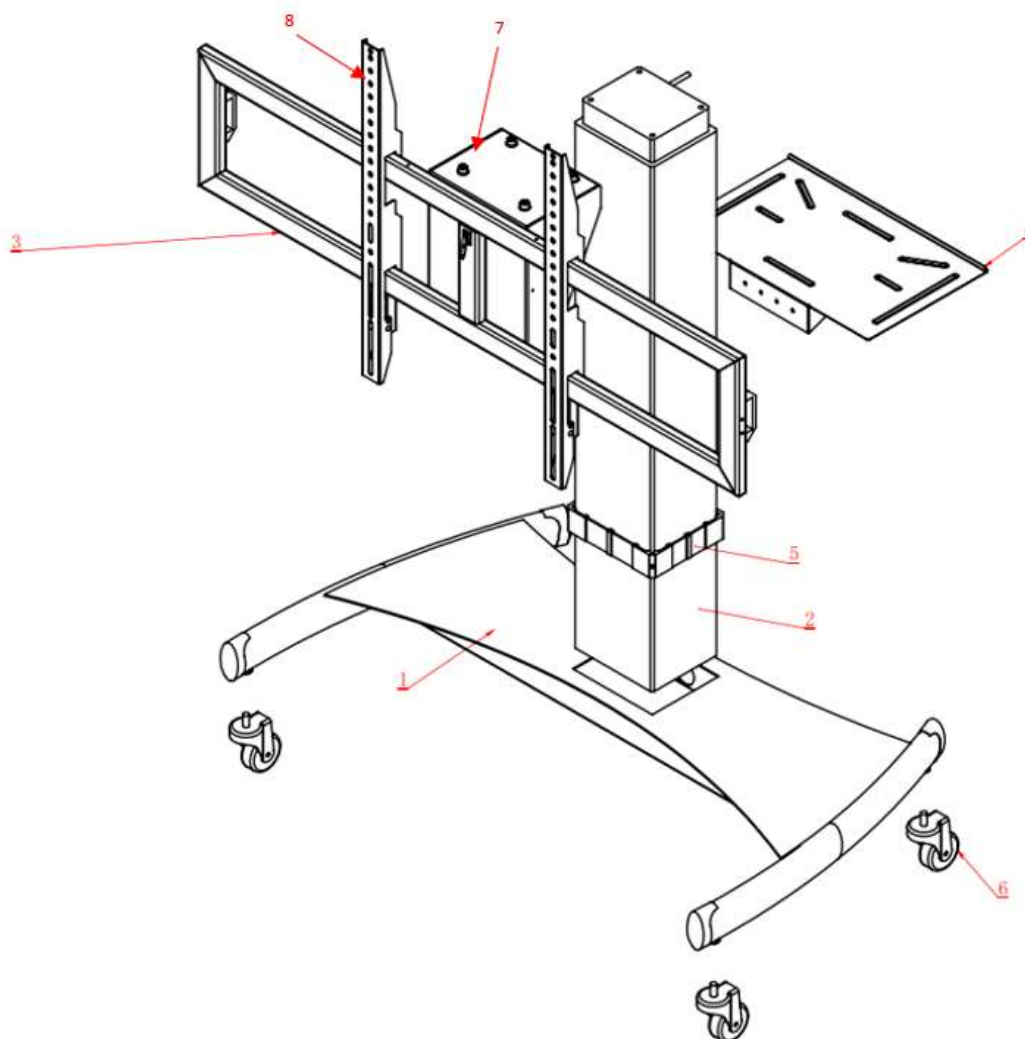

1. Mobile Base
2. Extrusion
3. Screen Mounting Frame
4. Laptop Tray
5. Laptop Tray Collar
6. Castors
7. Extrusion Cap
8. Screen Bracket

## System Build

### Step 1 – Installing the Castors to the Mobile Base

- Install the 4 x Castors (6) to the Mobile Base (1) and tighten securely

### Step 2 – Installing the Extrusion into the Mobile Base

- Install the Extrusion (2) into the Mobile Base (1). Align the power cable into the hole in the base whilst installing to avoid damage to the power cable. Secure the Mobile Base (1) using 4 x M10 x 30mm Bolts and 4 x M10 Washers

### Step 3 – Installing the Laptop Tray Collar and Laptop Tray

- Install the Laptop Tray Collar (5) onto the Extrusion (2). At this point choose if the Laptop Tray (4) will protrude from the front or back of the Mobile Stand and install the Laptop Tray Collar accordingly. Set the Laptop Tray Collar (5) to the required height and tighten Grub Screw on Laptop Tray Collar (5) securely
- Install Laptop Tray (4) to Laptop Tray Collar (5) using 2 x M6 x 10mm Bolts and 2 x M6 Washers

### Step 4 – Installing the Extrusion Cap and Screen Mounting Frame to the Extrusion

- Install the Screen Mounting Frame (3) to the Extrusion Cap (7) using 4 x M8 x 15mm Bolts and 4 x M8 Washers
- Install the assembled Screen Mounting Frame (3) to the Extrusion Cap (7) to the Extrusion (2) using 4 x M10 x 30mm Bolts and 4 x M10 Washers

## Power and Cabling

### Step 5 – Installing the PDU

- Install the PDU to the top of the Extrusion Cap (7) using 2 x M4 Bolts and 2 x M4 Large Diameter Washers
- Connect the PDU IEC Power Cable to the Extrusion IEC Power Cable.



## Step 6 – Installing the Power Supply Bracket and Power Supply

- Install the Power Supply Bracket to the right side of the Extrusion Cap (7) using 2 x M4 Bolts. Install the Power Supply into the Bracket with the Figure 8 Inlet facing upwards. Connect the Figure 8 Cable from the Power Supply to the PDU



## Step 7 – Installing the Controller and Plastic Clip

- Install the Plastic Clip to the left side of the Extrusion Cap (7) using 2 x M4 Bolts. The centre locating lug on the Plastic Clip should face downwards
- Insert the Controller onto the Plastic Clip. Ensure that the power cable coming from the Controller is facing the rear of the stand and the connectors are facing forward
- Route the cable from the Controller through the Cable Clip and around the front of the Screen Mounting Frame (3). Connect the Controller Cable to the Power Supply Cable and secure using Cable Clips



- Install the Din4 Extension Cable into the 4 pin connector on the Controller. Route the Din4 Extension Cable around the front of the Screen Mounting Frame (3) and connect to the Din4 Cable from the Extrusion (2). Secure the cable using the Cable Clip on the front of the Screen Mounting Frame (3)

## Step 8 – Installing the Up / Down Switch

- Connect the Up/Down Switch to the 8 pin DIN connector on the Controller
- Install the Up/Down Switch Plastic Holder to the right hand outside of the Screen Mounting Frame using 2 x M4 Bolts
- Place the Up/Down Switch into the Plastic Holder and secure cable through Cable Clip



## Step 9– Quality Assurance and Testing

- Thoroughly inspect the System for correct installation, ensuring all parts are correctly tightened and secure. Ensure all cables are secured using Cable Clips and no binding free movement whilst operating between the highest and lowest screen position.

## Step 10 - Installing LED Screen to Assembled Stand

- Included with this Mounting System are 2 x Screen Brackets (8) to provide an VESA interface for mounting the LED Screen to the assembled system. Please consult your LED Screen manufacturer technical details on how the screen should be mounted to a bracket mount system. After the LED Panel has been to the assembled system ensure the Safety Locks on the Screen Brackets are installed and secured. Safety Locks cannot be installed to the Screen Brackets until after the Led Panel has been installed onto the assembled stand. TouchBoard does not recommend the use or 3<sup>rd</sup> party mounting brackets installed between the LED Screen and 2 x Screen Brackets.

If Additional Technical Support is required during installation, please contact TouchBoard on +61404778829 or contact your local supplier.